



Glass Divider

The Sneeze Guard Company

Project Name: _____

Location: _____

Item #: _____ Qty: _____

Date: _____

Model: **C144**

Class: Sneeze Guard - Full Service - (45° viewing shield)

Model C144 is part of the Crystalline Series featuring the elegant all glass look. The C144 Full Service (pass over) Sneeze Guard is characterized by the clean look of the vertical face and 45° viewing shield. The maximum bay size for this family is 60" and is available in 1/4", 3/8", or 1/2" safety tempered glass. There are four styles of crystal clear support which meet most any full-serve needs. Multiple bay units have a continuous smooth front shield and can be combined with the model C124 self service sneeze guard to make a seamless transition from full service to self service. Custom sizes available. Always review your sneeze guard plans with your health department.



- Crystal Clear 1/2" Safety Tempered Glass Supports
- Large Bay Size (Up to 60" between supports)
- Optional Removable Internal Shelves
- Four Standard Support Styles
- Chrome Finish Hardware



Support Options:

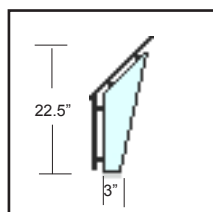

Open

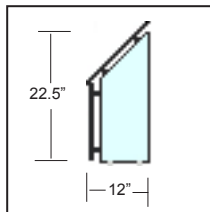

Closed
12" Depth

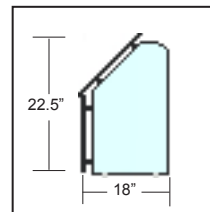

Deep
18" Depth

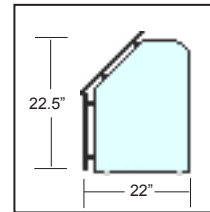

Extended
22" Depth

Options & Accessories

Glass Options

- ☐ 1/4", 3/8", or 1/2" Glass
- ☐ Crystal Clear Glass
- ☐ Removable Mid-Shelf (11", 17", 21")
- ☐ Radius Corners
- ☐ Frosted Logo
- ☐ Frosted Glass

Mounting Options

- ☐ Tab Feet
- ☐ U-Channel
- ☐ Flanged Boot

Accessories

- ☐ LED Edge Lights
- ☐ LED Lights
- ☐ Logo Lights



The "Deep" or "Extended" supports are required as end supports on NSF certified sneeze guards. The "Open", and "Closed" supports can be used for internal supports in multi-bay configurations

